



PORT LOCKROY 2021-22

Visitor Guidelines and Working Together





VISITOR GUIDELINES

INTRODUCTION

The UK Antarctic Heritage Trust (UKAHT, registered charity no. 1160847) has produced this information sheet which provides the essential information you need to know before visiting us at Goudier Island. This should be read alongside the [Antarctic Treaty visitor site guidelines for Goudier Island](#).

You are very welcome to visit Base A, Port Lockroy this season and we look forward to seeing you. Our team, however, will not be on site until at least mid-January 2022 and their main focus will be on conservation, essential maintenance and monitoring, as well as offering a postal service. Therefore, regrettably, we are not able to open the gift shop and would like to offer alternative options to you and your guests. Please read our 'Working Together' section below for the details.

Visits to the museum are very welcome however we just ask that you consider who may have visited Base A immediately before your visit and the lack of ventilation within Bransfield House. Due to maintenance work later in the season, our Covid-19 protocols include the closure of the museum whilst our team are working within the building. Our Base Leader or Antarctic Operations Manager can confirm this ahead of your visit, so please do get in touch.

PREPARING FOR A VISIT

Visits to Port Lockroy should be booked via the IAATO ship scheduler as usual and any subsequent changes should also be made through the IAATO ship scheduler.

Our team will be on site from mid-January 2022; we, therefore, request visiting vessels contact the Antarctic Operations Manager, Lauren Luscombe lauren@ukaht.org 24 - 72 hours ahead of an intended visit to reconfirm the time and date. Our lockroy@ukaht.org email address will be monitored during this time as well.

You will be asked the following questions and reminded of the information below.

- How many guests do you plan to land?
- What are the main nationalities of your guests?
- Do you plan to land any crew?
- Do you have any special guests, visiting scientists, photographers/media or permits covering special activities at the site? And do they have any special requests/needs?

Items to bring ashore

Fresh water / Towels / Flags / Cones / Step / Shovel

- Please bring a shovel as you may have to dig snow steps at the Chains landing site upon arrival. Later in the season when the snowbank at the landing site has melted a step can be useful.
- Please ensure that boots are cleaned before entering Bransfield House. We recommend bringing at least 20 litres of freshwater, a tray and 6-8 towels for the boot-washing and drying process as guests enter Bransfield House.
- Please bring flags or cones to help mark paths and no-go areas. These areas also apply to Expedition Staff, and we ask you to respect these and follow the same paths/area as your guests. As role models to your guests, we often note they reflect behaviour.

Landing site

The preferred landing site is to the west of the Island, near the old whaling mooring chains. There is a path that leads directly to Bransfield House.

Early season conditions can be such that ice blocks the main Chains landing site, but zodiacs can still be landed at the Boatshed. Due to the density of penguins nesting close to the Boatshed and a main penguin highway entry and exit point to the sea on the route from the Boatshed to Bransfield House, it is very hard to conduct a visitor landing without causing a disturbance, **so we ask that you respect our request not to use this landing site this season.**



DURING A VISIT

1. The Boatshed: The smaller structure to the north of the Island is the Boatshed, constructed in 1957. There is **no access or entry to the Boatshed for visitors**.
2. Nissen Hut: The original 1944 building collapsed sometime in the 1990s. The Nissen hut now on site is a replica of the original and was reconstructed in 2010 as accommodation for the seasonal staff. It is private property for the team and is not part of the museum. Therefore, there is **no access or entry to the Nissen Hut for visitors**.
3. Please do not smoke or use matches, candles or stoves in or around the building.
4. The site is a designated Historic Site and Monument and therefore overnight stays should not be made.

Penguin Colonies

As part of the penguin monitoring study, half of the Island is off-limits. Please refer to the **Antarctic Treaty visitor site guidelines** and ensure that visitors and staff do not enter the control colonies. There are cameras set up around the Island to monitor the penguin colonies, including one at the top of the Anemometer tower that looks across the chains landing site area. The data and recordings from these cameras are gathered each season.

A basic map of the Island is below. This also highlights the different colonies found on the Island each year. It will never be exact, but this will give you some indication of where the colonies can be found.

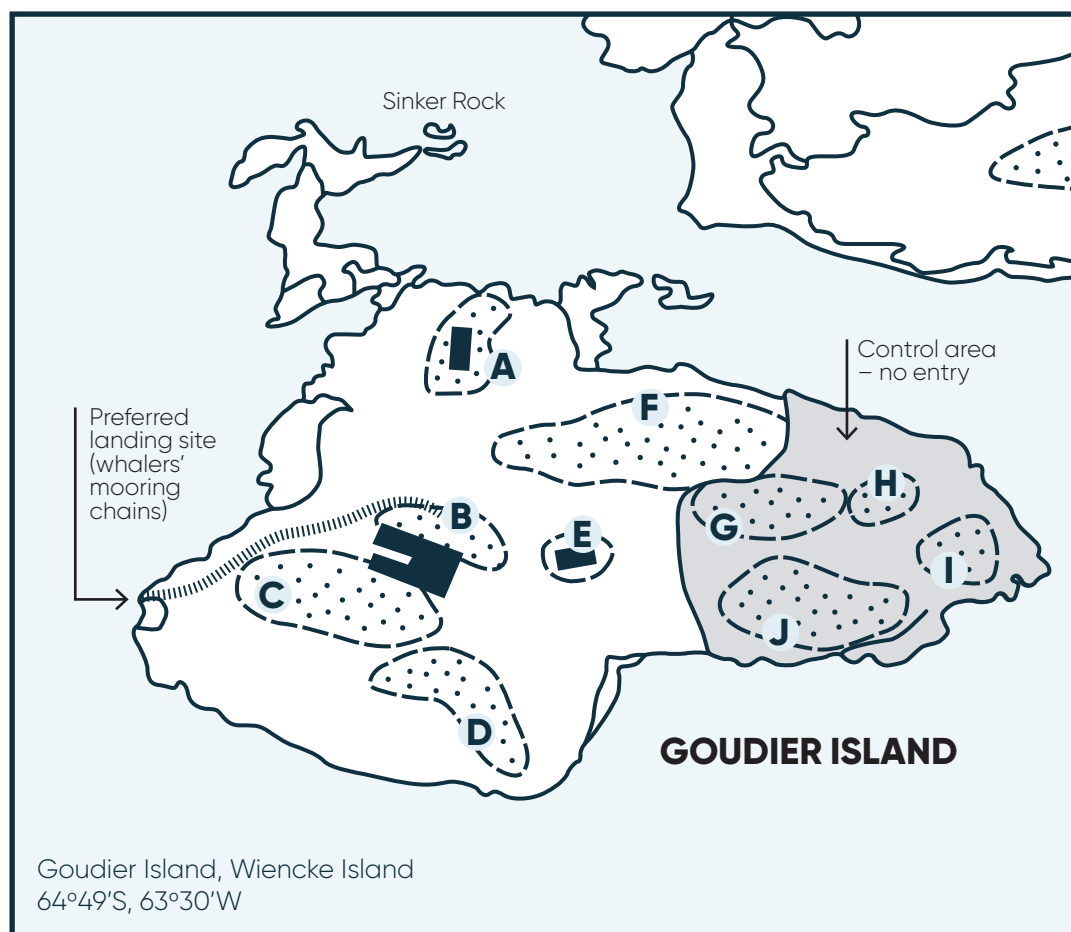
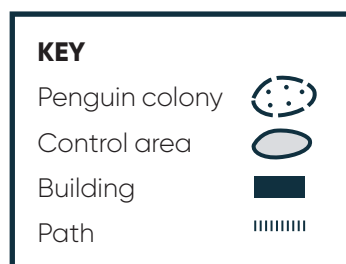



Visitor movement around the Island

Using data collected regarding the main penguin and human pathways, we ask that you **concentrate visitor activities on defined pathways**. The main reason we ask you to respect this is due to the recent analysis of the data taken from the published paper:

Dunn, M.J., Forcada, J., Jackson, J.A. *et al.* A long-term study of gentoo penguin (*Pygoscelis papua*) population trends at a major Antarctic tourist site, Goudier Island, Port Lockroy. *Biodivers Conserv* 28, 37–53 (2019).
<https://doi.org/10.1007/s10531-018-1635-6>

This paper found a decrease in breeding pairs; similar declines were evident in breeding pairs at six colonies visited by tourists as well as at four unvisited colonies. Analysis suggests a complex situation with different possible drivers of change, including climate change which we intend to study further by installing a weather station this season. For now, to protect the wildlife on Goudier Island and continue the long-term study, we ask that you respect our request to limit movement around the Island this season. We encourage you only to use the following paths: –

1. The pathway from the Chains landing site to Bransfield House and
2. The area in front of Bransfield House, including the wooden decking and ramp

Visiting Bransfield House

Visits to the Museum in Bransfield House are very welcome until the team arrive in mid-January 2022. Due to Covid-19 protocols, we kindly ask that you think carefully before entering Bransfield House and consider when the previous visit was. There isn't much ventilation in the museum and rooms and corridors are small. We would love to keep the museum open for your guests to explore and learn about this fascinating time in history; however, we want to ensure it is safe for all. Therefore, when the team is on site and working within the museum, it will be closed to visitors. We will also likely close it in the run-up to any work the team carries out to ensure their environment is as safe as we can make it.

You should note that the gift shop (old generator room) will be closed.

**Please see further notes regarding the postal service later on.*

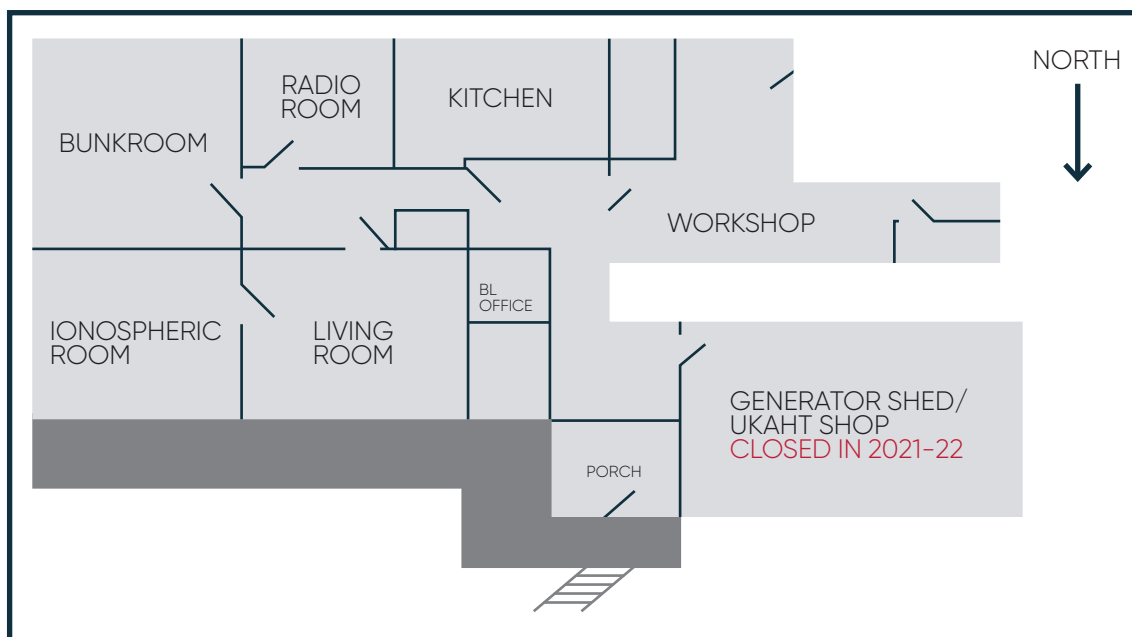

Floorplan of Bransfield House



Boot washing and drying before entering Bransfield House

The following procedures will help reduce damage to the building and its artefacts and we ask that you please assist us with this over the 2021-22 season.

We would like you to ensure all outdoor clothing and boots are clean and free of snow/gravel/guano as much as possible before entering the building. Preventing the floors from getting too wet or damp in the building will make a significant difference to the amount of moisture within the building, which in turn has a considerable impact on the artefacts held within. To assist you, inside the front porch you will find 1 bucket for water and 1 boot brush. **Please use these.** You may wish to bring your own or extras from your vessel to assist in this process.

We also encourage you to bring fresh water for your guests to rinse their boots in before they enter Bransfield House and some clean towels for the porch as this worked well in 2019-20 and kept the museum floors in good condition. If it is a wet day when you visit, please bring along extra towels so that you can clean and dry the floors before you leave.



Expedition team cleaning boots before entry



A towel on the porch to help keep the floors dry

Inside Bransfield House

- **Bags/rucksacks** – we request that all guests leave large bags outside on the deck or wear them on their fronts to improve their awareness as they move through the building with its narrow corridors and small rooms. Your help with this is much appreciated.
- **Hiking poles** – all guests should leave hiking poles outside Bransfield House.
- **Wet/dry suits** – if you have guests doing water sports, we request they go back to the ship and change out of wetsuits etc., before coming ashore if they want to enter Bransfield House.
- Please do not try and remove external window shutters
- In the past, the UKAHT team would leave large 'dust' sheets up in the museum. A decision was made to stop this practice.
- Ionospheric room papers – UKAHT found that moving these each season is more damaging than leaving them in place where they are, so we ask you not touch or move them.
- Where there are curtains, they will be closed to protect artefacts from light damage. We ask you to leave them closed.
- Please enjoy looking around and reading the interpretation boards, but we kindly ask that you **do not touch or move the artefacts.**



- Please do not turn on light switches as the power in Bransfield House will not be turned on. Lights are normally turned on in the Base Leaders Office, Darkroom, Workshop, Radio room and Bathroom, so these rooms might be quite dark. Torches might be helpful on cloudy/overcast days.
- Some of the more delicate museum artefacts have been packaged and stored over the winter and will not be on display.
- We will leave a visitor book in the lounge/living room for you and your guests to sign.

Please report any visible damage to the buildings or leaks in Bransfield House to the Antarctic Operations Manager, Lauren Luscombe: lauren@ukaht.org or info@ukaht.org – photos can also be very helpful to document any issues.

We are hugely grateful for your cooperation and if you have the time, we would appreciate hearing about your visit.

Departing

1. We ask that you leave the building as you find it
2. Please ensure that the hut is clean on your departure and that snow/water is mopped up from the floors and they are left clean and dry
3. Please remember to put the bucket and boot brush back inside the porch
4. Please check that all windows, curtains, and doors are closed
5. Please make sure the front door is securely closed and bolted to prevent any snow entry

Health and Safety

Port Lockroy is a historic site and includes buildings constructed in the 1940's and 1950's. It is important to make you aware that it was common during this era to use materials that contain hazardous substances, including asbestos, lead, mercury etc. The UK Antarctic Heritage Trust (UKAHT) takes the Health and Safety of all visitors to this site extremely seriously and as such, is currently working with conservation experts on a work program to ensure these buildings are as safe as possible for all visitors; however, please note that you do enter all of these historic sites at your own risk. If you require any further information, please do not hesitate to contact us.





WORKING TOGETHER 2021-22

INTRODUCTION

With the reverberations of the Covid-19 pandemic still being felt by all, like many organisation the UK Antarctic Heritage Trust was unable to operate in the 2020/21 season which had a significant impact on our charity.

With a reduced 2021/22 season, we are looking at alternative ways that we can best continue to support operators and your guest experience, and in turn how our partners may be able to help raise awareness and donations for UKAHT. We would like to share ideas around working differently with you this season.



Antarctic Heritage Trust Information Sheet 2021-22

PORT LOCKROY, BASE A

Goudier Island, Wiencke Island 64°49'S, 63°30'W

Historic Site and Monument No 61



UK
**ANTARCTIC
HERITAGE
TRUST**

POSTAL SERVICE IN 2021-22

The Post Office will be in operation for you and your guests this season; however, postcards will only be processed when the team arrive in mid-January 2022.

Visiting between November 2021 and mid-January 2022 (before the team arrive)

1. You can post mail in the post box if British Antarctic Territory (BAT) stamps are attached.
2. If you do not have stamps, please leave the correct amount of money for stamps (attached to the cards or put in an envelope together with the mail) and we will attach a stamp on your behalf.
Stamps are £2 / \$2 / €2 each.

We can only accept USD, EUR or GBP. We cannot process \$2 notes or EUR500 or any other currencies.

If the correct postage is not left, postcards cannot be processed.

If you have a large amount of post (more than 50 postcards)

Please bundle the cards and leave it in a box or bag along with the following:

1. A note with the following details: -
 - Total number of postcards
 - The name of the vessel
 - Your date of visit
 - Name of the Expedition Leader
2. If stamps are required, it is more secure for us to take payment via invoice – to arrange an invoice, please contact the UKAHT Administration Manager, Lisa Avis – lisa@ukaht.org.
3. If this is not possible, you can leave the correct amount of cash in a sealed smaller bag or envelope with the mail. It is important to note that UKAHT does not leave any cash on site, so if you choose this option, UKAHT cannot take responsibility for this, and anything left is at the senders' risk. Please remember that any cash left is left unsecured and could be left for up to 10 weeks until the team can collect this. Due to this, **we strongly encourage payment to be made via invoice.**

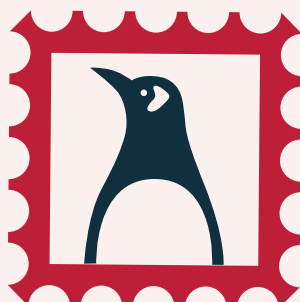

4. All mail will be collected and processed from January 2022.

Please note that we can only accept mail that includes British Antarctic Territory (BAT) stamps. Mail with stamps from South Georgia or the Falkland Islands should be sent directly to the Post Office in Stanley and any with Argentine stamps can only be processed in Argentina.

Visiting between mid-January and March 2022 (once the team are on site)

Once the team are on site there will be an opportunity for your vessel to buy postcards and stamps in bulk and pay via invoice.

Buying postcards in bulk

We have printed and boxed in 500s for your guests, our iconic penguin postcard which are available to any operator who will be landing in the Falkland Islands prior to January 2022 through prior arrangement.

Payment for the postcards can be made via invoice, along with 500 stamps. This would mean you have purchased all your postcards and stamps upfront and your passengers can write them at their leisure before arriving at Port Lockroy where they can be dropped off, cancelled and sent in the post by our team.



Antarctic Heritage Trust Information Sheet 2021-22

PORT LOCKROY, BASE A

Goudier Island, Wiencke Island 64°49'S, 63°30'W

Historic Site and Monument No 61



UK
**ANTARCTIC
HERITAGE**
TRUST



ON-BOARD AUCTIONS

Some operators hold on-board auctions with the proceeds being donated in whole or in part to UKAHT. Of course, with Covid-19 bubbles in mind there are limitations on whether we can provide items for auctions. However, one item that is always a winner is a flat Sheet 1A & 1B Graham Land & South Shetland Islands map beautifully illustrated with images of flora and fauna encountered on your expedition which is normally drawn by either an expedition team or crew member. We do not hold flat maps at Port Lockroy, but we could post these to you. Please do get in touch to discuss a specific auction prize for your ships.

GUEST WEBINARS

We would love the opportunity to offer a webinar to your guests – prior to departure, or depending upon the strength of your comms whilst they are onboard. This would give guests an opportunity to hear some of the unique stories, discoveries and histories of Antarctica and Port Lockroy and some of the other bases that we care for. Guests can also find out how to Adopt a Penguin and help support UKAHT if they would like to.

FILMS FOR GUESTS

We have a number of introductory films about our work and Antarctica's heritage that offer an interesting insight into our sites and work. Please get in touch if you would like to show one of these on board to guests.

ONLINE SHOP & PENGUIN ADOPTIONS

A unique range of Antarctic gifts are available through our online shop, and every purchase helps to support UKAHT and our work to preserve sites in Antarctica. Payment can easily be taken from each passenger and their items could be waiting for them at home when they return! We are also offering some exciting new ranges of clothing that will not be available at Port Lockroy.

<https://www.ukaht.org/shop/>

Our new Adopt a Penguin scheme enables guests to follow a unique colony at the end of the world. We'd be grateful if you would consider telling your guests about our shop and scheme through your marketing and communications. <https://www.ukaht.org/support-us/adopt-a-penguin/>.

MARKETING & AUDIENCE REACH

We are always keen to speak to our partners about creative ways in which to engage those with a passion for Antarctica. UKAHT has a dedicated and keen audience committed to supporting and visiting the region, and our projects have genuine impact in the world of digital, education, the environment, community and heritage. As a charity, we rely on support and sponsorship to deliver our projects and care for our sites, and we love to work in partnership. To discuss opportunities and to share ideas, please get in touch with camilla.johns@ukaht.org.

IN SUMMARY

We would like to work with you so that we can help each other in these times. Please do not hesitate to contact us if you have any questions at all. Your support is very gratefully received and we hope you enjoy your visit.

Thank you.

**The UK Antarctic Heritage
Trust team**